

**USE TO SECURE PIM SHIELD RAILS TO STAINLESS STEEL BRACKETS.
USE 900360-10 TO SECURE RAILS TO GALVANIZED STEEL BRACKETS.**

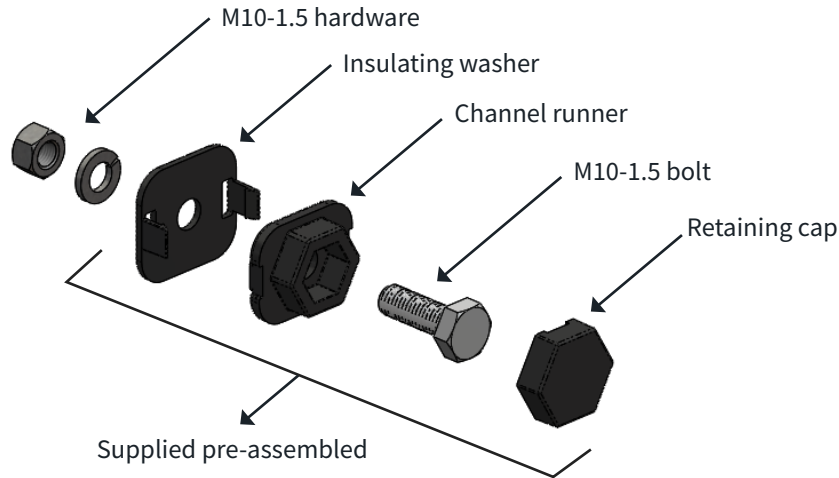

SPECIFICATIONS

General	PIM Shield Channel Runner Kit provides a low passive intermodulation method to secure PIM Shield Rails (sold separately) to stainless steel mounting brackets in the high-risk PIM zone. The channel runner assembly slides inside the rail extrusion and provides insulation between the aluminum rail and the stainless-steel mounting hardware.
Grip range	0.25 inch (thickest stainless-steel bracket that a rail can be secured to using this kit)
Rail attachment hardware	M10-1.5 x 30 mm, stainless steel
System PIM performance (when tested at next higher assembly)	IM3 <-100 dBm when tested in accordance with proposed IEC 62037-8, near field test, 2x 20W test tones, while subjected to dynamic stimulus. To achieve specified PIM performance, torque all M10 hardware to 15 FT- LB (ConcealFab tool 900412)
Channel runner material	UV stable, glass filled Nylon
Operating temperature	-40°C to +70°C
Shipping dimensions	8.5-inch x 8.5-inch x 9 inch
Shipping weight	14.1 lb.
Qty per package	10 kits of 10